

# Mailbox announcer/ WITH BELL PUSH

Postvarsler/Postaviserare/Posti-ja ovikello

– Stop walking in vain for mail!



2 YEARS WARRANTY

Congratulations with your new mailbox announcer. This instruction manual explains the product and we advise you to read this carefully so that proper use is ensured. The instruction manual should be kept as long as the mailbox announcer is in use.

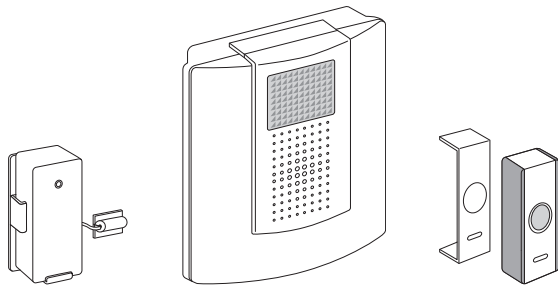

## CONTENTS:

- 1 Mailbox switch unit
- 1 Push Button unit
- 1 Mailbox announcer
- 2 stk. 12v (A23) alkaline batteries
- Extra cover for bell push
- Fittings.

## IN GENERAL:

No wiring is required for this Mailbox Announcer Kit. When the Mailbox Switch unit is activated, it sends a wireless signal to the Mailbox Announcer that activates the chime sound. Since the operating range is up to 50 metre (165ft approx. – in open field), you can mount or take the Mailbox Announcer virtually anywhere in the home. However the transmission range of the wireless signal will be reduced if the signal is transmitter through a number of walls or ceilings. Metal and UPVC doorframes will also reduce the operating range.

## BATTERY INSTALLATION:

### MAILBOX SWITCH UNIT:

1. Remove the back of case by pushing in the tab on the bottom with a small, flat screwdriver.
2. Insert 1 x 12volt battery (A23 – included) in the battery compartment, ensuring the battery polarity match the internal markings.

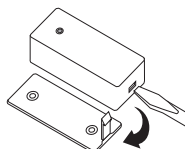

3. Snap the front cover of push button back on, then it is ready to use.

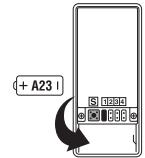

### PUSH BUTTON UNIT:

1. Push button unit is operated by 1 x 12volt A23 alkaline battery (included)
2. Open up the push button and insert 1 x 12volt battery in battery compartment. Close again and the Push Button is ready for use.

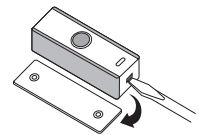

### REPLACE THE BATTERY:

Open up the push button by pushing in the tab on the bottom with a small, flat screwdriver, then replace the battery (1x12volt A23) ensuring the battery polarity match the internal markings (“+” face upward). Snap the back cover of Push Button back on.

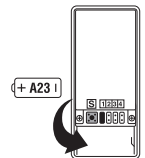

### MAILBOX ANNOUNCER UNIT:

1. Remove the battery cover from the back of the unit by sliding it away from the unit.
2. Insert 4 x 1.5volt alkaline batteries (“AA”, UM3 & LR6 - not supplied) into the battery compartment, ensuring the battery polarity match the internal markings.
3. Close the battery door, then the chime unit is ready to use.
4. Alternatively the unit can be powered by an A/C – D/C 6-9volt 300mA adaptor.

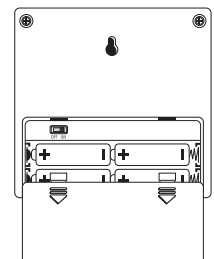

*Please make sure to remove any batteries from the unit when using the plug adaptor to power the chime unit.*

## INSTALLATION GUIDE:

### MAILBOX SWITCH UNIT:

1. Use the Velcro adhesive pad (included) fix the mailbox switch unit onto inner surface of the mailbox opener/flap. Firstly, stick the Velcro-loop pad onto the mailbox opener/flap at the position close to the transmitter unit. The switch unit comes with Velcro-hook pad; stick it onto the Velcro-loop pad. Adjust the angle of the switch unit 30° - 45° vertical to the mailbox opener/flap. Test to ensure that it will activate the transmitter when the mailbox opener/flap is opened. If necessary, adjust the angle of

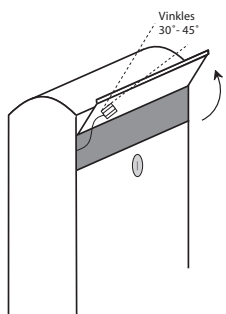

**TOP OPENING:**  
With door opening outward

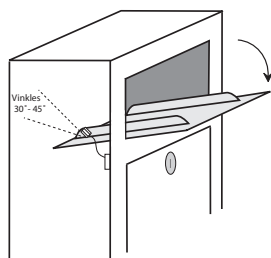

**HINGED AT THE BOTTOM**  
With door opening outward

the switch unit against the mailbox opener/flap again to obtain better performance. No matter what angle is adjusted, make sure that the switch will activate the transmitter only when the mailbox opener/flap is fully opened.

- Use the double adhesive pad fix the transmitter unit onto the inner surface of the mailbox. In order to get the best performance; it is better to mount the unit close to the opening of mailbox opener/flap, so that the wireless signal can travel through the opening. Test to ensure that it is working perfectly with the Mailbox Announcer unit before final installation.

#### PUSH BUTTON UNIT:

- Using the two holes of the back of push button as a template, mark the fixing position for the unit. Drill two holes and fit wall plugs and secure the Bell Push Unit with screws (self-tapping 3 x 16mm screw) in position, or by the double-sided self-adhesive pad (included), onto your front door or the position nearby. When mounting to masonry, fit wall plugs. When mounting to wooden doorframe wall plugs are not necessary.

**Important:** Mounting the Push Button unit on the UPVC door-frames or metal surface will reduce. The broadcasting range seriously.

#### MAILBOX ANNOUNCER UNIT:

This announcer unit can be completely portable, or fix it in one place. It has one slotted hang hole on the rear; this hole will enable the Chime unit to be hooked onto a screw and easily removed or relocated to another room.

Drill a hole then fit wall plug (if fixing to masonry) and screw (self-tapping 3 x 16mm screw) to fixing position. Leave a gap of 3mm

between the screw head and the wall. Locate the keyhole slot on the back of the unit over the screw.

#### MELODY SELECTION:

The melody selector is located inside the Push Button unit and inside the Mailbox switch unit. A small switch inside the battery compartment marked with "S". Press the switch once, the melody will change to play the next one on the list, there are total of 8 melodies for selection.

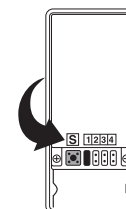

- |                      |                        |
|----------------------|------------------------|
| 1 / Westminster      | 5 / Banjo on my knee   |
| 2 / Ding Dong repeat | 6 / Twinkle-twinkle    |
| 3 / Telephone Ring   | 7 / It's a small world |
| 4 / Circus Theme     | 8 / Dog Barking        |

#### DIGITAL CODE SET UP:

The encoded frequency of the Mailbox Switch, Push Button and Mailbox Announcer units can be changed to avoid interference from any similar unit operated nearby on the same frequency digital code. After battery installation on Mailbox Switch, Push Button and Mailbox Announcer units and follow the procedure below to change the operating code.

##### 1. Mail Box Announcer:

It is built with Learning Code ability therefore no setting is needed.

##### 2. Mailbox Switch AND Push Button:

- There is 4 black links in a row, in position 1, 2, 3 & 4, which can be altered to achieve total sixteen (16) possible digital codes.
- Add or remove one or more the black link(s), in any combination then activate the mailbox switch and Push Bell to send a wireless signal to the Door Chime unit which will sound to indicate that a new operation code is registered and memorised.

##### 3. Test to ensure correct operation before final installation.

*Note: If the chime unit sounds for no reason during the digital code setting, it is indicated that it has been interfered by other similar chime unit nearby, reset the digital code as above procedure.*

#### MAILBOX ANNOUNCER OPERATION:

When the mailbox opener/flap being opened, the Mailbox Switch will activate the transmitter, LED indicator will light up during wireless signal transmission for 1 second, and Mailbox Announcer unit will sound, as well as the "Letter" sign indicator will light up. The sound will stop as soon as the melody ends. "Letter" sign indicator will stay on until override button being pressed to reset the unit. Important: Always reset the Announcer unit after it is being activated, then it is ready for the next operation.

[ MAILBOX ANNOUNCER / WITH BELL PUSH - ITEM NO. 32911 ]

## DOOR CHIME OPERATION:

Press the button on the Push Button unit once, it sends a wireless signal to the Door Chime, Door Chime unit will sound. The sound will stop as soon as the melody ends. For repeat sound, press the button again. Hold the button in will NOT repeat the sound.

## APPROVALS:



## RECYCLING:

Do not discard the unit with household waste, but in compliance with currently enforced regulations. In compliance with the Directive 2002/96/CE relative to waste from electrical and electronic equipment (WEEE) this product must be recycled.



## IMPORTANT:

1. During Mailbox switch installation, test to ensure it is working perfectly with the Mailbox Announcer unit before final installation.
2. Do not mount the Push Button onto any metal surfaces or UPVC doorframe, as this will reduce the operation range seriously.
3. Do not mount either unit close to fireplace or expose to high temperature.
4. Do not use different type of batteries, or mix up old and new batteries.
5. Batteries should be inserted and removed by an adult only.
6. Always use alkaline batteries. Please dispose of old, defective batteries in an environmentally friendly manner in accordance with the relevant legislation.
7. Make sure that no naked flame sources, such as lighted candles, should be placed on the unit.
8. The unit should not be exposed to dripping or splashing and no objects filled with liquids, such as vases, should be placed on the unit.

**CAUTION:** Make sure batteries are installed correctly as per the internal markings.

**CAUTION:** Replace only with the same or equivalent type of battery that is recommended by the manufacturer.

**CAUTION:** Danger of explosion if battery is incorrectly installed or replaced.

**IMPORTANT:** There are no serviceable parts in the units, do not attempt to repair it.

## USER HINT:

If the Mail Box Announcer unit does not sound, please check the following:

1. Flat batteries in either Push Button or Mailbox Switch or Mail Box Announcer units – change the batteries.
2. Wrong battery polarity in either Push Button or Mailbox Switch or Mail Box Announcer units – reinsert the batteries.
3. Push Button, Mailbox Switch or Mail Box Announcer units are not on the same operation codes – reset the code (see digital code set up).
4. Push Button and Mail Box Announcer units did not register the operation code after change of battery – reset the code (see digital code set up).
5. Mail Box Announcer unit does not register any operation code after batteries changed – reset the code (see digital code set up).
6. Units are out of range - Operate the Chime unit within the operation range.

## TECNICAL SPECIFICATION:

### MAILBOX SWITCH:

Battery: 1 x 12v alkaline A23  
Power consumption: on: 3,0 mA – off: 0,003 mA

–

### CHIME:

Battery: 4 X 1,5V alkaline LR6 (AA)  
Transformer: 6-9v – 300 mA mrf 3,5 mm . Plug  
„+“ in midt pole

Power consumption: on: 100 mA – standby: 0,3 mA

–

### PUSH BELL:

Battery: 1 x 12v A23 alkaline batteri

–

Operating temperature: 0 – +35 C°

Range: Op til 50 meter

Melodies: 8

Codes: Mailbox switch: 16  
Bell Push: 16

**R2 Device** - device where the sound output is created by the initial operation of the control and when the period of sound output continues for the designed duration irrespective of condition of the control.

For more information go to [www.ensonordic.com](http://www.ensonordic.com)

01.08.2017